

PARAGUARD ROOF PERIMETER SYSTEMS



Siplast Paraguard and Siplast Proform, specifically engineered and fabricated for use with Siplast Roof Systems, are the industry's premier metal roof edge coping, and expansion joint systems. Multi-component Paraguard Systems are designed for easy installation and maximum weather-tight construction.

The Paraguard Raised Edge features a galvanized steel waterdam/cant that can be installed at the start of a Siplast membrane application, allowing phased construction between layers of the roof system. The fascia component is installed after the roofing is completed, facilitating continuous weather-tight installation. Paraguard Coping has a galvanized steel anchor cleat plate with pre-punched holes for correct fastener placement and a specially designed guttered splice plate for smoother finish lines.

Paraguard Expansion Joint Cover has a galvanized steel traveler cleat system designed and fabricated to allow for building (tensile and shear) movement beneath the metal cap cover.

Factory-applied Paraguard finishes are available in 27 standard colors, in both pre-finished aluminum and galvanized steel. Paraguard colors can also be customized.

Siplast Paraguard Raised Edge

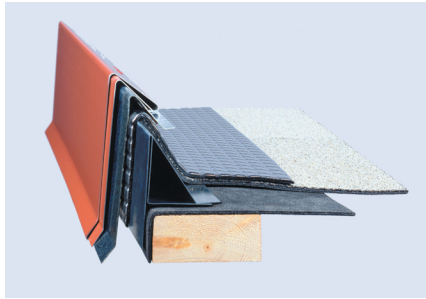

The Siplast Paraguard Raised Edge System features:

- A simple design that allows for ease of installation without special tools or equipment.
- A galvanized steel cant dam with pre-punched nailing holes for correct nail placement.
- Prefabricated, welded corner starters (inside and outside) and leveling angles for accurate cant dam installation.
- A system design that isolates expansion/contraction of the fascia panel from the Siplast membrane.
- No exposed fasteners.
- Concealed splice plates for smoother finish lines.
- A prefabricated welded aluminum sump pan and spillout scupper with flanges designed specifically for interfacing with modified bitumen membrane systems.
- Fascia available in formed aluminum or steel.
- Standard factory-formed miter corners and end caps.
- FM Approved Class 1-285 Windstorm Classification for Roof Perimeter Fascia Systems.

Siplast Paraguard Coping



Siplast Paraguard Coping features:

- A galvanized steel anchor cleat plate with pre-punched holes for correct fastener placement.
- A specially designed metal guttered splice plate for smoother finish lines.
- Cap metal available in aluminum or steel.
- Standard factory formed miter corners and end caps.
- No exposed fasteners.
- FM Approved up to 1-180 Windstorm Classification for Roof Perimeter Fascia Systems.



Siplast

1000 E. Rochelle Blvd.,
Irving, Texas 75062
469-995-2200
Facsimile: 469-995-2205

In Canada:

201 Bewicke Ave., Suite 210
North Vancouver, BC, Canada V7M 3M7
604-929-7687

Customer Service in North America:
Toll Free 1-800-922-8800

www.siplast.com
www.siplastgreen.com

Siplast Proform Gravel Stop

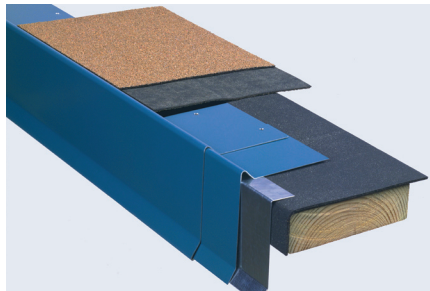

The Siplast Proform Gravel Stop features:

- A continuous galvanized steel cleat with pre-punched holes for correct fastener placement.
- Pre-punched nailing holes in the nailer flange for correct nail placement.
- Factory-formed miter corners.
- Concealed splice plates for smoother finish lines.
- No exposed fasteners.
- Paraguard Roof Perimeter Systems and Proform Gravel Stop are approved by FM Approvals for Class 1 Wind-storm Classifications when fabricated and installed according to FM Approvals requirements, and also meet ANSI/SPRI ES-1 standards for roof perimeter components.

The Siplast Proform

Fascia Extender features:

- Continuous galvanized steel cleat with pre-punched holes for correct fastener placement.
- Pre-punched holes in the extender panel for correct fastener placement.
- Color finish matches finishes of standard Paraguard and Proform perimeter systems.
- Factory formed miter corners.
- Concealed splice plates for smoother finish lines.
- No exposed fasteners.

Siplast Paraguard Roof-to-Roof and Roof-to-Wall Expansion Joint Covers

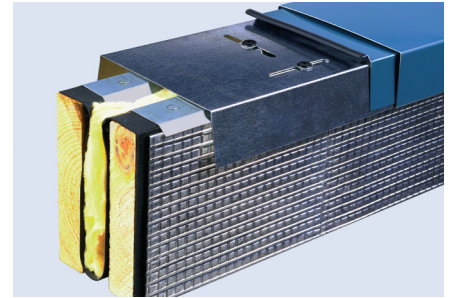

The Siplast Paraguard Expansion Joint Cover System features:

- A galvanized steel traveler cleat system fabricated and designed to allow for building tensile and shear movement beneath the cap metal cover.
- Specially designed shouldered cleat fasteners to allow for traveler cleat movement.
- A flexible membrane condensate seal/insulation retainer.
- A specially designed metal guttered splice plate for smoother finish lines.
- Fiberglass batt insulation.
- Cap metal available in formed steel or aluminum.
- No exposed fasteners.