

CHANGE OF DECK PLAIN DETAIL

PARASOLO PVC ROOF MEMBRANE - RIGID INSULATION (ALL SYSTEMS)

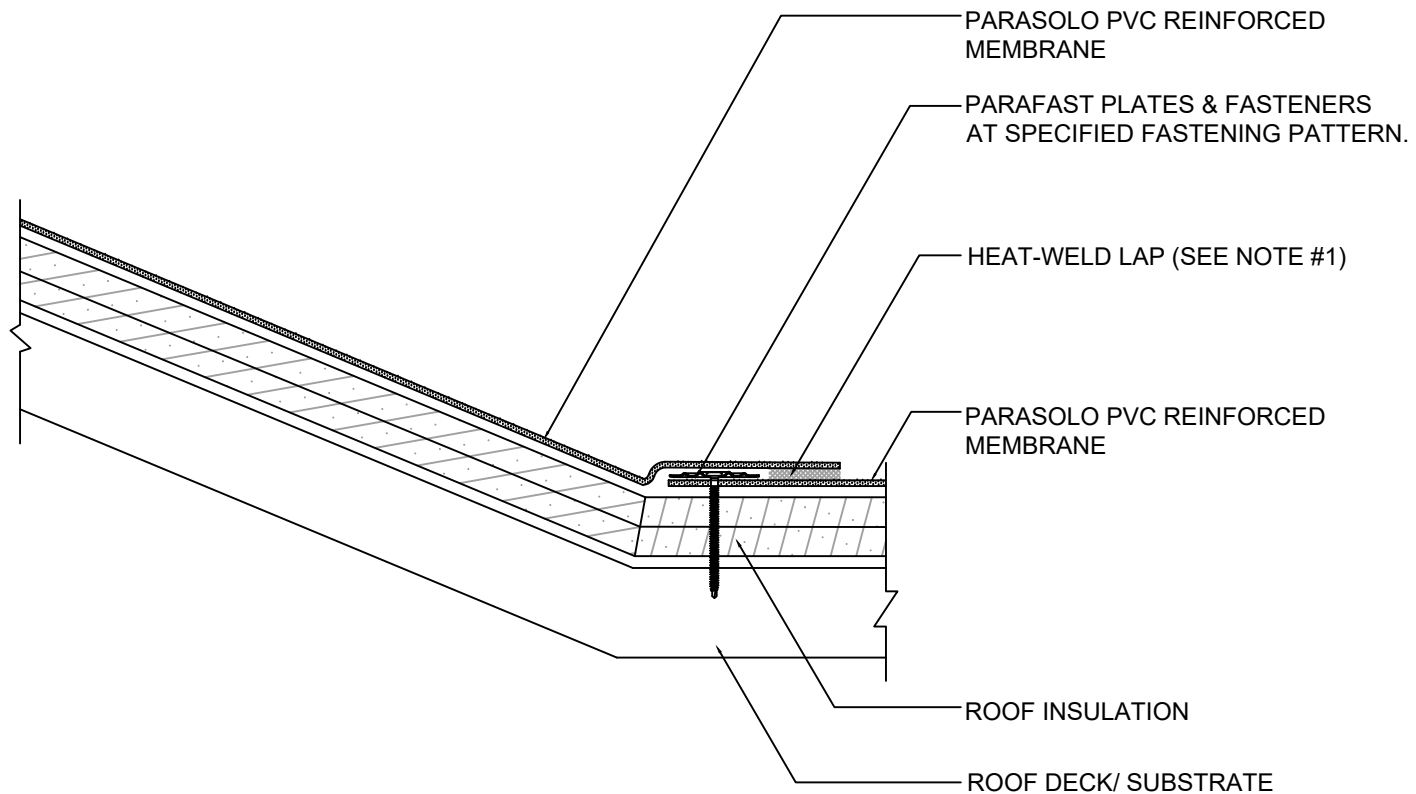

NOTES:

1. FOR HEAT-WELDING LAPS USE 1.5" MIN. WELD WITH AUTOMATIC MACHINE WELDER AND 2" MIN. WELD WITH HAND WELDER.
2. ALL OTHER SLOPES 1:12 OR GREAT NEED TO BE FASTENED AT ANGLE CHANGE.

N.T.S