

DRAIN with INTER-PLY PARAPRO FLASHING

PARASOLO HYBRID SYSTEM - RIGID INSULATION

OVERHEAD VIEW

PARADIENE 20 (fully adhere)
 PARAPRO 123 FLASHING SYSTEM
 (extend a minimum 8" beyond outermost edge of drain)
 PARADIENE 20
 (fully adhere, lap a minimum of 4" beyond Parapro Flashing)
 MASTIC
 (set all roof layers above Parapro Flashing in Parasolo
 Water-Block Sealant 6" around drain perimeter)
 PARASOLO PVC FLEECE-BACK (adhere, see note #3)
 STRAINER & CLAMPING RING

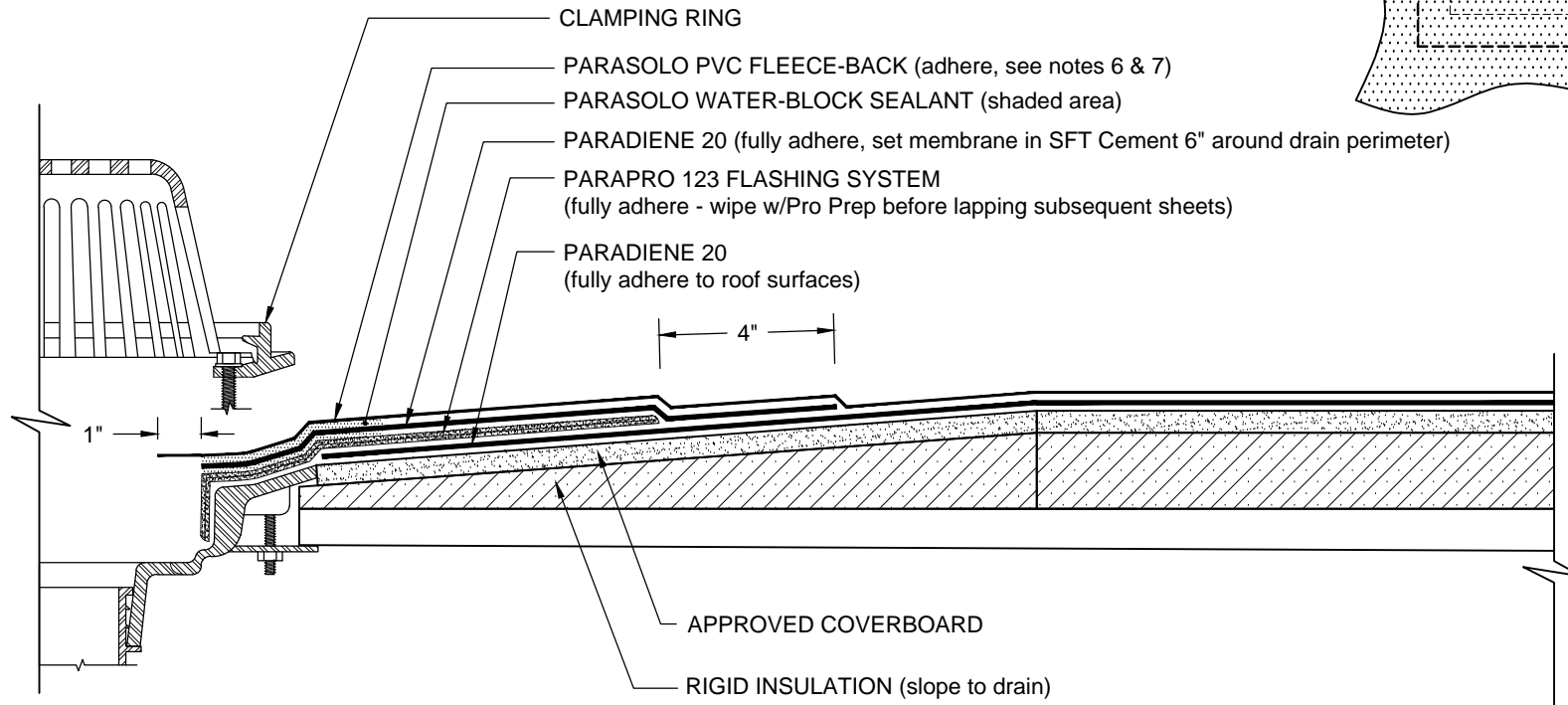
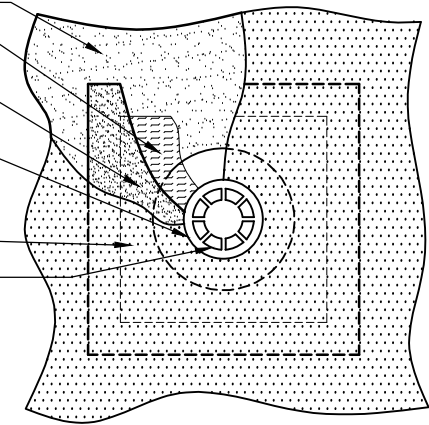

NOTES:

1. WHERE PRIMER IS INDICATED TO MAINTAIN PROPER ADHESION, USE PA-1125 OR PA-917 LS PRIMER. CONTACT SIPLAST FOR SPECIFIC REQUIREMENTS.
2. CLEAN/WIPE THE SURFACE OF THE CURED PARAPRO 123 FLASHING WITH PRO PREP AND ALLOW TO DRY PRIOR TO APPLICATION OF THE PARADIENE 20 STRIPPING PLY.
3. ROOF DRAIN COMPONENTS AND INSTALLATION GUIDELINES ARE SUPPLIED BY THE DRAIN MANUFACTURER.
4. REFER TO SIPLAST PREPARATION GUIDELINES FOR PROPER SURFACE TREATMENT OF ALL MATERIALS PRIOR TO APPLICATION OF PARAPRO FLASHING MATERIALS.
5. REFER TO SIPLAST FLEECE CUTTING RECOMMENDATIONS FOR CONFIGURATIONS, CUTTING, FOLDING, AND LAPPING TECHNIQUES.
6. SET PARASOLO MEMBRANE IN PARASOLO WATER-BLOCK SEALANT 6" AROUND THE DRAIN PERIMETER.
7. MEMBRANE MUST EXTEND MINIMUM 1" BEYOND THE BOLT HOLES. THE CLAMPING RING BOLTS MUST PENETRATE THE MEMBRANE.
8. REQUIREMENTS AND RECOMMENDATIONS DETAILED IN THE CURRENT SIPLAST SPECIFICATIONS SHALL APPLY IN ADDITION TO THE ABOVE DRAWING.

CAUTION: SIPLAST RECOMMENDS THAT ALL PRACTICES PERTAINING TO NRCA CERTA GUIDELINES BE FOLLOWED WHEN TORCHING METHODS ARE EMPLOYED. THIS INCLUDES PERFORMING A FIRE WATCH FOLLOWING ANY TORCH APPLICATIONS. ALWAYS HAVE APPROVED FIRE-EXTINGUISHING EQUIPMENT NEARBY.

N.T.S