

# ROOF MEMBRANE LAYOUT - ADHERED DETAIL

## PARASOLO PVC ROOF MEMBRANE - RIGID INSULATION (ADHERED SYSTEM)

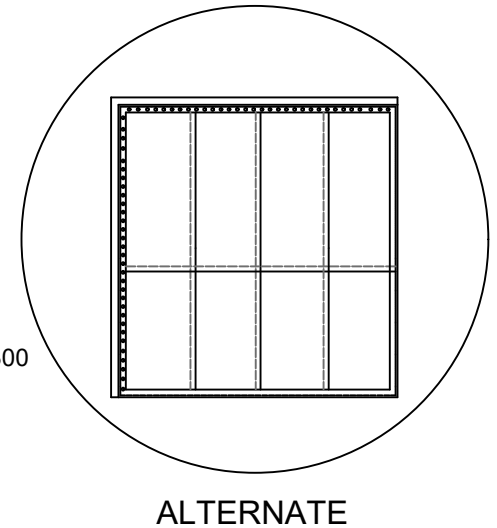
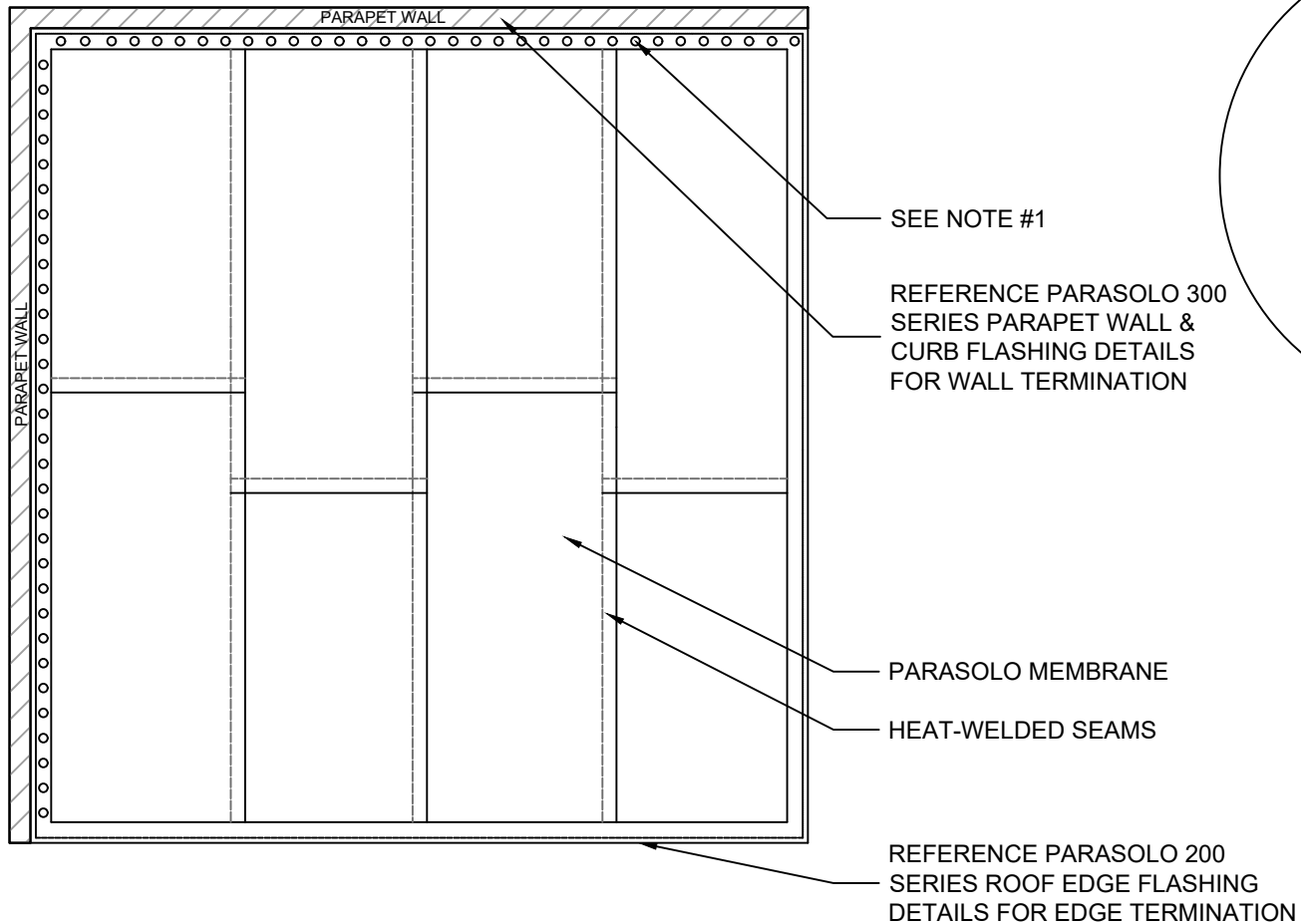

**NOTES:**

1. SEE PARASOLO ADHERED SYSTEM TECHNICAL GUIDELINES TO DETERMINE PERIMETER AND PENETRATION FASTENER SPACING FOR VARIOUS DECK TYPES AND WIND UPLIFT REQUIREMENTS.

N.T.S