

SUMPED ROOF DRAIN WITH PARAPRO/PARAFLEX 531 LIQUID FLASHING PARASOLO PVC ROOF MEMBRANE - RIGID INSULATION (ALL SYSTEMS)

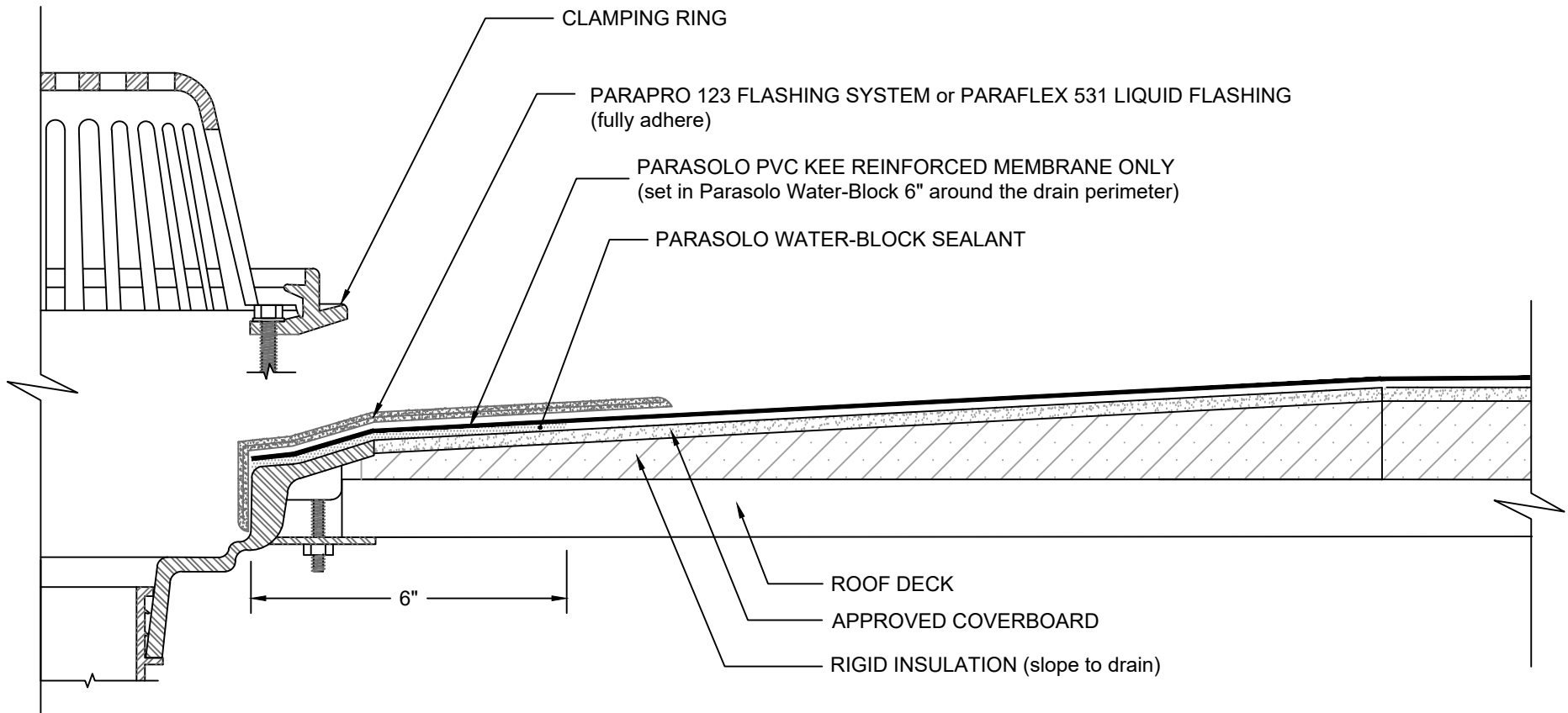

NOTES:

1. REFER TO SIPLAST PREPARATION GUIDELINES FOR PROPER SURFACE TREATMENT OF ALL MATERIALS PRIOR TO APPLICATION OF PARAPRO FLASHING MATERIALS.
2. ROOF DRAIN COMPONENTS AND INSTALLATION SPECIFICATIONS ARE SUPPLIED BY THE DRAIN MANUFACTURER.
3. REQUIREMENTS AND RECOMMENDATIONS DETAILED IN CURRENT SIPLAST SPECIFICATIONS SHALL APPLY IN ADDITION TO THE ABOVE DRAWING.

N.T.S