

SUMPED ROOF DRAIN WITH PARAFLEX 531 LIQUID FLASHING

PARADIENE 20/30 FR - INSULATED

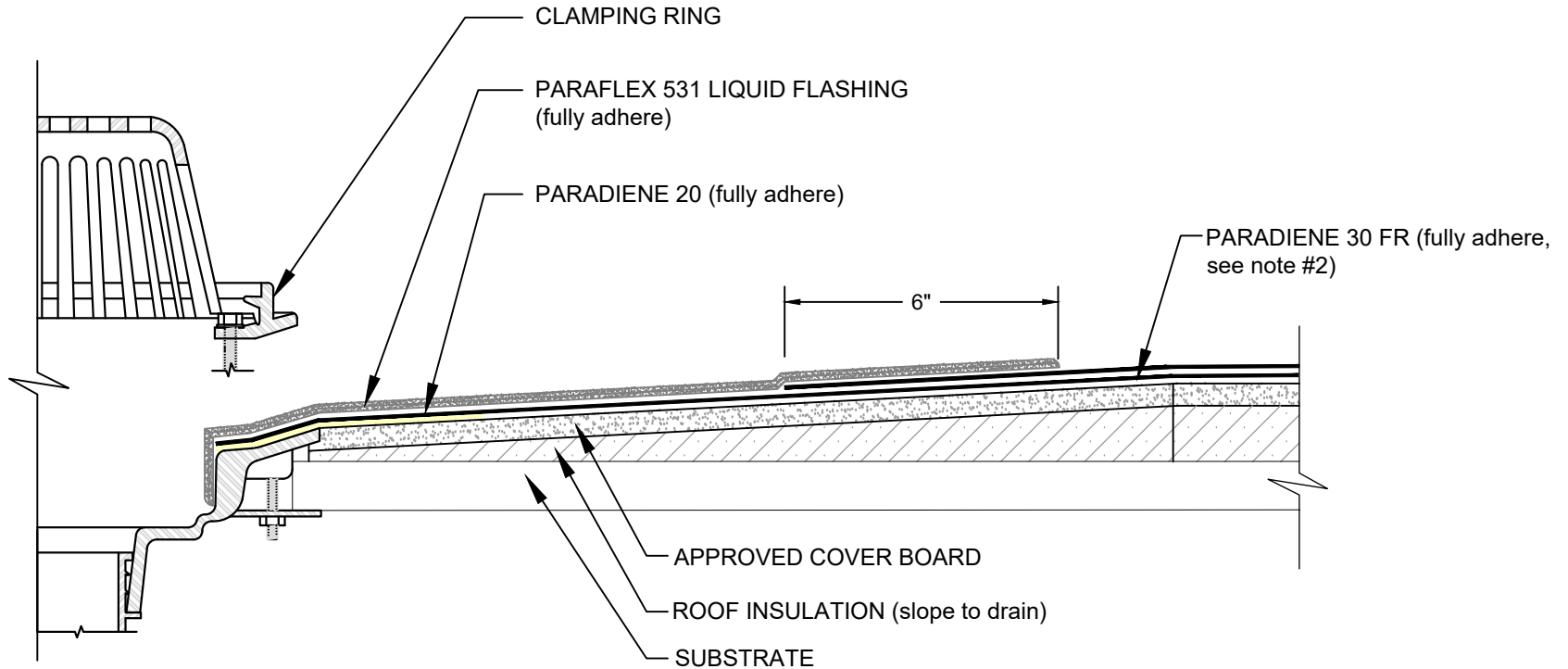

- NOTES:
1. CLEAN/WIPE THE SURFACE OF THE CURED PARAFLEX 531 LIQUID FLASHING WITH PRO PREP CC AND ALLOW TO DRY PRIOR TO LAPPING SUBSEQUENT SHEETS.
 2. PARAFLEX CANNOT BE APPLIED IN THE ABOVE CONFIGURATION OVER MEMBRANES OR OTHER MATERIALS CONTAINING UNCURED, SOLVENT-BASED MATERIALS. IN SUCH CASES, MEMBRANES TO BE COVERED WITH PARAFLEX MUST BE ADHERED WITH SFT ADHESIVE, SFT H CEMENT, OR PS-715 NS ELASTOMERIC SEALANT. CONTACT SIPLAST FOR TREATMENT OPTIONS OF CONDITIONS UTILIZING A BASE PLY APPLIED IN SOLVENT BASED ADHESIVE.
 3. PRIME THE PARADIENE SHEETS USING PRO PRIMER AC TO MAINTAIN A CONSISTENT AESTHETIC APPEARANCE OF THE FINISHED PARAFLEX SYSTEM.
 4. REQUIREMENTS AND RECOMMENDATIONS DETAILED IN CURRENT SIPLAST SPECIFICATIONS AND THE PARAFLEX 531 LIQUID FLASHING INSTALLERS GUIDE SHALL APPLY IN ADDITION TO THE ABOVE DRAWING.

CAUTION: SIPLAST RECOMMENDS THAT ALL PRACTICES PERTAINING TO INDUSTRY STANDARD TORCH SAFETY REQUIREMENTS AND GUIDELINES BE FOLLOWED. THIS INCLUDES PERFORMING A FIRE WATCH FOLLOWING ANY TORCH APPLICATIONS. ALWAYS HAVE APPROVED FIRE EXTINGUISHING EQUIPMENT NEARBY WHEN USING A TORCH.

Scale: NTS

REF: SUMPED ROOF DRAIN WITH PARAFLEX 531 LIQUID FLASHING - PARADIENE 20/30 - INSULATED

Detail Number:
DE-SBS-00-02c



14911 Quorum Drive, Suite 600 - Dallas, Texas - 75254 (800) 922-8800

www.siplast.com

Rev: 02.09.2024